

### BG Series

Clean and See Through Displaying,  
Innovative Transparent Technology

- Excellent Viewing Angle
- Hidden Cable Appearance
- Easy to Install and Dismantle
- Extremely versatile and highly customizable



Attn.: Tracy  
 Email Address: sales20@bakovisionled.com  
 Whatsapp/Mobile Number: +86 15367558232

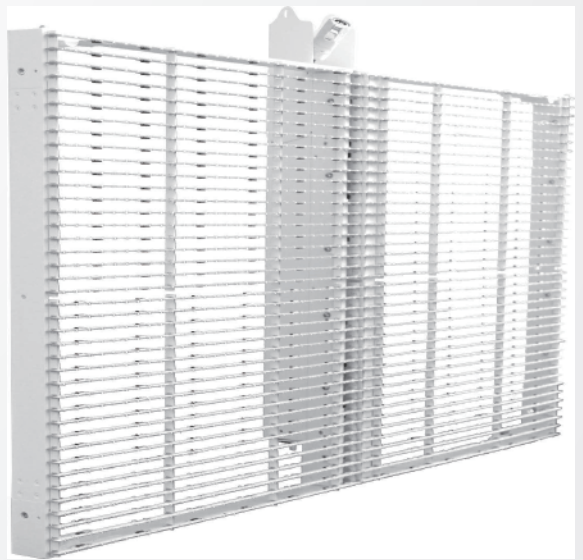

#### Slim, Light Weight and Quiet

- › 35mm-45mm thickness
- › 14kg per square meter
- › Available to attach onto glass wall directly

#### High Transparency and Concise

- › 60-80% transparency rate among different pitches
- › Variable brightness options for day and night environment
- › Hidden cable design looks clean and concise

#### Customizable and Versatile

- › Unlimited orientation, highly customizable
- › Suitable for any size and shape
- › Convex, concave, wave, cylindrical, fit any indoor architectural structures

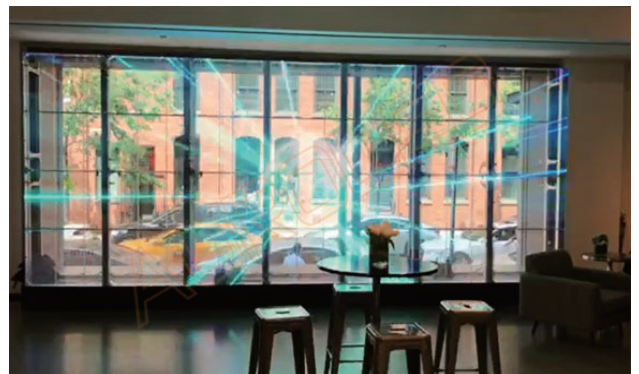

## BG / Specifications

	BG-2.5-7.8	BG-3.9-7.8	BG-5-8	BG-10	BG-16
Physical Pitch	2.5 × 7.8 mm	3.9 × 7.8 mm	5 × 8 mm	10.4 × 10.4 mm	16 × 16 mm
Pixel Configuration	SMD 1921	SMD 1921	SMD 1921	SMD 1921	SMD 1921
Pixel Density	50,688 pixels/m <sup>2</sup>	32,256 pixels/m <sup>2</sup>	25,000pixels/m <sup>2</sup>	9,216 pixels/m <sup>2</sup>	3,906 pixels/m <sup>2</sup>
Module Dimensions (W × H) (mm)	500 × 125	500 × 125	480 × 320	500 × 125	480 × 320
Panel Dimensions (mm)	1000 × 500	1000 × 500	960 × 640	1000× 500	960 × 640
NO.of Modules Per Panel (W × H)	2 × 4	2 × 4	2 × 2	2 × 4	2 × 2
Physical Resolution of Module (W × H)	200 × 16	128 × 16	96 × 40	48 × 12	30 × 20
Physical Resolution of Panel (W × H)	400 × 64	256 × 64	192 × 80	96 × 48	60 × 40
Panel Material	Aluminum	Aluminum	Aluminum	Aluminum	Aluminum
Weight	<14 kg/m <sup>2</sup>	<14 kg/m <sup>2</sup>	<14 kg/m <sup>2</sup>	<14 kg/m <sup>2</sup>	<14 kg/m <sup>2</sup>
Gray Scale	16 bit	16 bit	16 bit	16 bit	16 bit
Colours	281 trillion	281 trillion	281 trillion	281 trillion	281 trillion
Contrast Ratio	2,000 : 1	2,000 : 1	2,000 : 1	2,000 : 1	2,000 : 1
Average Power Consumption	240 W/m <sup>2</sup>	180 W/m <sup>2</sup>	203 W/m <sup>2</sup>	140 W/m <sup>2</sup>	218 W/m <sup>2</sup>
Max Power Consumption	700 W/m <sup>2</sup>	560 W/m <sup>2</sup>	670 W/m <sup>2</sup>	400 W/m <sup>2</sup>	650 W/m <sup>2</sup>
Operating Temp/Humidity	-10 C - 60 C / 10% - 60%	-10 C - 60 C / 10% - 60%	-10 C - 60 C / 10% - 60%	-10 C - 60 C / 10% - 60%	-10 C - 60 C / 10% - 60%
Storage Temp/Humidity	-30 C - 60 C / 10% - 60%	-30 C - 60 C / 10% - 60%	-30 C - 60 C / 10% - 60%	-30 C - 60 C / 10% - 60%	-30 C - 60 C / 10% - 60%
Refresh Rate	>1,920 Hz	>1,920 Hz	>1,920 Hz	>1,920 Hz	>1,920 Hz
Brightness	1,000~4,200 nits	1,000~4,200 nits	>5,500 nits	1,000~4,200 nits	>5,500nits
Horizontal Viewing Angle	160°	160°	160°	160°	160°
Vertical Viewing Angle	140°	140°	140°	140°	140°
Expected Lifetime	100,000 Hrs	100,000 Hrs	100,000 Hrs	100,000 Hrs	100,000 Hrs
IP Rating (Front/Rear)	IP 30	IP 30	IP 30	IP 30	IP 30
Servicing	Rear	Rear	Rear	Rear	Rear
Scan Method	1/11 Scan	1/7 Scan	1/6 Scan	1/2 or 1/4 Scan	Static Scan

## Typical Applications:

- Building Construction
- Shopping Mall
- Trade Show
- Rental Tour
- Fashion Store
- KTV
- Car Show
- Chain Store
- Theme Resort
- Window Display
- Hotel
- Company Reception